

Olomouc Region



Contents



- Introduction of the region
- Selected industrial zones
- Selected development sites
- Selected brownfields

Basic data

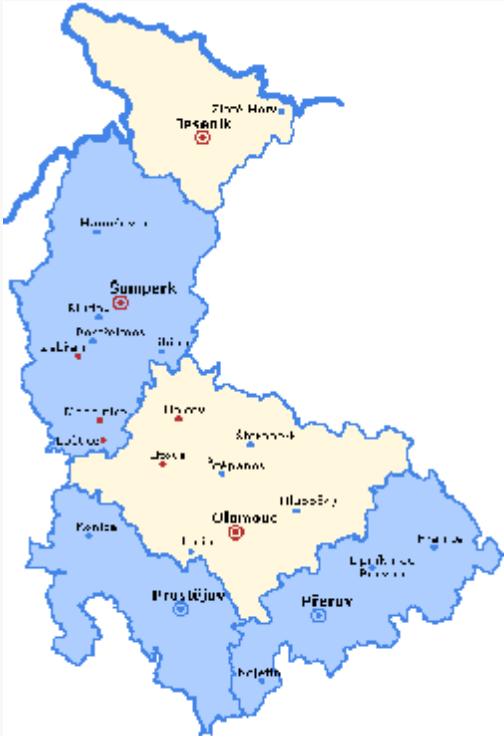

- unemployment – 9%
- Jeseník 14.7%
- Prostějov 6.2%
- average wages – EUR 583 (2nd lowest)



Traditional sectors



-- Mechanical engineering:

Hanácké železářny a pérovny a.s., SIGMA GROUP a.s., Pramet Tools s.r.o., Pars Nova Šumperk a.s., UNEX a.s., Strojtos Lipník a.s.

-- Electrical engineering:

MORA Moravia a.s., NH Zábřeh a.s., SEV Litovel s.r.o., M.L.S. Holice, spol. s r.o.

-- Clothing and textiles:

Oděvní podnik a.s.

-- Leather and footwear:

Gala a.s., KAZETO spol. s r.o.

-- Optics and precision mechanics:

Meopta – optika a.s.

Development of the business environment in the region – traditional sectors



-- Food:

A. W. spol. s r. o., Nestlé Česko s.r.o. závod Zora Olomouc, Pivovar Litovel a.s., Pivovar Holba a.s., Pivovar Zubr a.s., Sladovny Souflet ČR a.s., Olma a.s., Palírna u Zelného stromu – Starorežná k.s., Moravský lihovar a.s., ALIBONA a.s., Hanácká kyselka s.r.o., Cukrovar Vrbátky a.s., Váhala a spol. s.r.o., Solné mlýny a.s.

-- Paper:

Olšanské papírny a.s., Závod Velké Losiny, OP papírna Olšany, s.r.o.

-- Chemical and pharmaceuticals:

Precheza a.s., Farmak a.s.

-- Plastics:

MetalPlast Lipník nad Bečvou a.s

-- Other:

GMMS, spol. s r.o., Metrie spol. s r.o., RapoSklo, spol. s r.o.

Results of Czech Beer 2006 competition

Pale Lager Category

1. Litovel Premium
2. Staropramen Lager
3. Zubr Premium

Pale Draft Category

1. Starobrno Traditional
2. Zubr Gold
3. Holba Šerák

Selected foreign investments



TORAY



Nápady pro
budoucnost automobilů

OLYMPUS

Mubea
engineering for mobility



Invensys™

Miele

wanzi



peamei

Honeywell

me opta



SIEMENS

WESTCOMBE
Business Research Limited

TIMKEN



Wienerberger

senior
Automotive
Senior Automotive Czech s.r.o.

Education



- 3 bilingual high schools (English, Spanish, French)
- 24 secondary technical schools and training centres

- Palacký University / 20,000
- Moravian University Olomouc / 265
- College of Logistics / 200
- TUL department – Prostějov / 75
- detached workplace of the Faculty of Engineering of TU Ostrava – Šumperk / 60



Clusters



- Czech Trailers and Accessories Cluster
- Czech Nanotechnology Cluster



Expressways



Expressways	R 46	Brno – Olomouc (connected to D1)
	R35	Mohelnice - Olomouc - Lipník nad Bečvou (connected to D47)

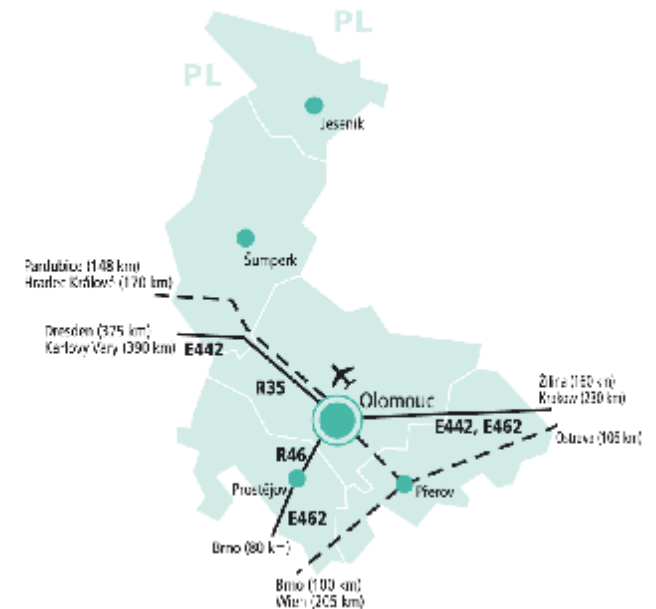
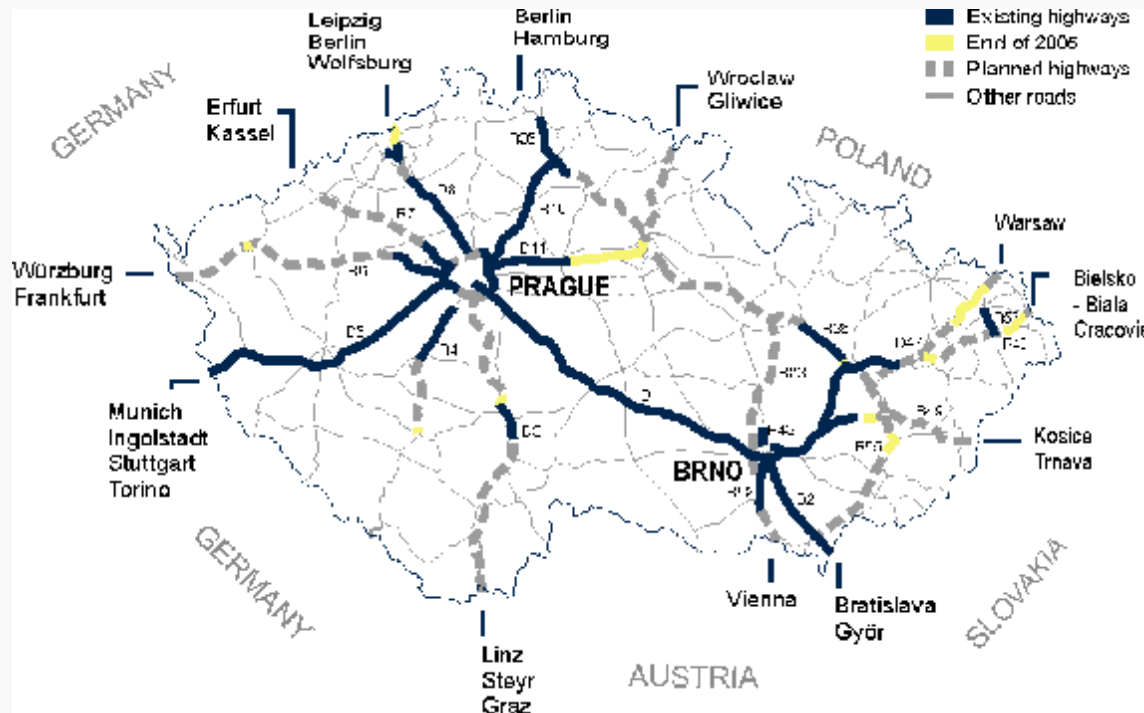

Railways, airports



International railways

270, 280, 300

2nd railway corridor

3rd railway corridor

- (Prague) - Česká Třebová – **Zábřeh** – **Olomouc** – **Přerov** – **Hranice n.M.** - Ostrava – (Krakow/PL)
- **Hranice n.M.** – Valašské Meziříčí – Vsetín – (Púchov/SK)
- **Přerov** – Otrokovice – Břeclav – (Bratislava/SK) – (Vienna/A)
- Gdansk/PL – Warsaw/PL - Ostrava – **Hranice n.M.** – **Přerov** – Břeclav,
- Le Havre/FR – Paris/FR – Frankfurt am Main/D – Prague – **Zábřeh** – **Olomouc** – **Přerov** – **Hranice n.M.** – Ostrava – Košice/SK – Lvov/UKR

Airports

Prague – Ruzyně (280km), Brno Tuřany (70 km), Ostrava Mošnov (83 km)

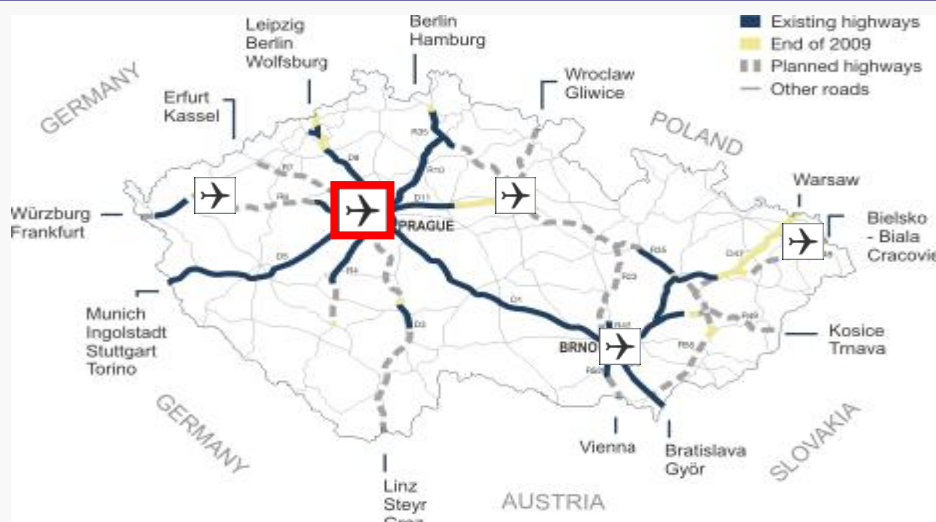

Source: City Invest Czech 2006/2007

Leisure-time tips



- **Jeseníky** offers possibilities for hiking, cycling and skiing
 - **spas** – Teplice nad Bečvou, Slatinice, Velké Losiny, Priessnitz curative spa in Jeseník, Karlova Studánka
 - **castles and chateaux** – Bouzov, Velké Losiny Chateau, Úsov Chateau, Šternberk Castle, Náměšť na Hané Chateau, Čechy pod Kosířem Chateau, Tovačov, Helfštýn Castle
 - **religious monuments** - Svatý Kopeček, Holy Trinity Column (UNESCO), Cathedral of St. Vaclav in Olomouc
 - Golf Club Olomouc, Svatý Kopeček Zoo
 - Moravian Theatre, Moravian Philharmonic in Olomouc
- ... <http://www.kr-olomoucky.cz/OlomouckyKraj/aplikace/TOP10/index.htm>



Industrial zones



- Prostějov - Sector G
- Lipník nad Bečvou

Industrial zones

Prostějov - Sector G



-- approx. 40 ha

-- of which sold: 17 ha

-- of which owned by city: 7.4 ha

-- of which privately owned: 15.9 ha

-- all infrastructural nets where completely finished in December 2006



Industrial zones

Lipník nad Bečvou



- CTP Invest / 8 ha
- First phase 15ha, total built up area approx. 80,000sq m which is mix of flexi space buildings ideal for small requirements starting 1500sq m or start up solutions for logistics / manufacturing. Warehouse properties and built to lease in accordance with clients requirements, first buildings available mid 2007, all land plots are flat, serviced and zoned for logistics and manufacturing.

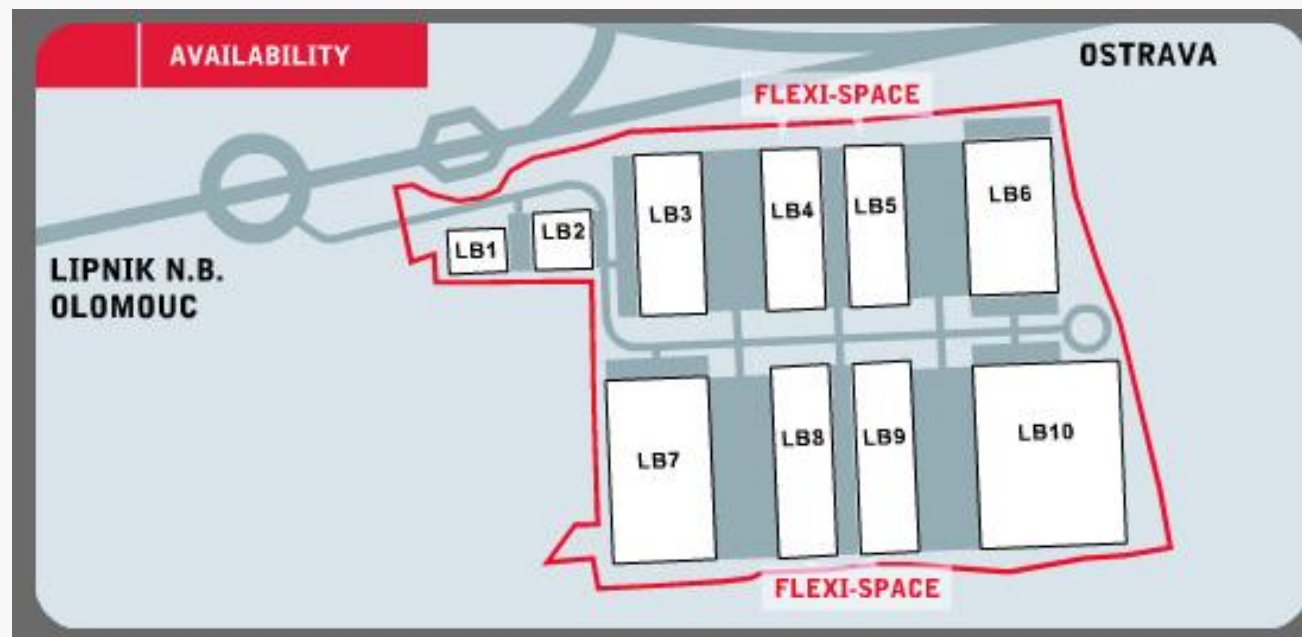

Development sites



- Lipník – PZ1
- Jezernice
- Olomouc – Příkopy

Development sites

Lipník – PZ1

- 16 ha
- eastern outskirts of the city in the direction toward Hranice.
- City of Lipník nad Bečvou has prepared project documentation for land and construction permission for utilities networks and transport connections for the entire industrial zone.
- Utilities networks currently lead to boundary of IZ III (southern part of the industrial zone)
- Planned capacity of utilities networks:

electricity	3MW	
gas	200 m ³ /h	DN 150
water	3,9 l/s	DN 150
sewerage	3,9 l/s	DN 300
drain	1692 l/s	DN600 – 1000

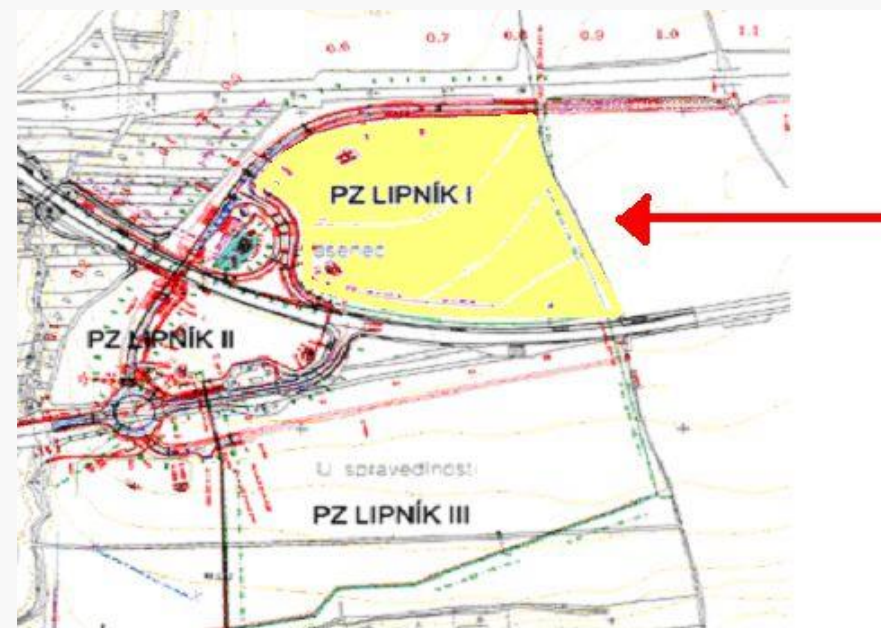

Development sites

Jezernice



- 16 ha
- the ownership is not solved
- direct connection to R35

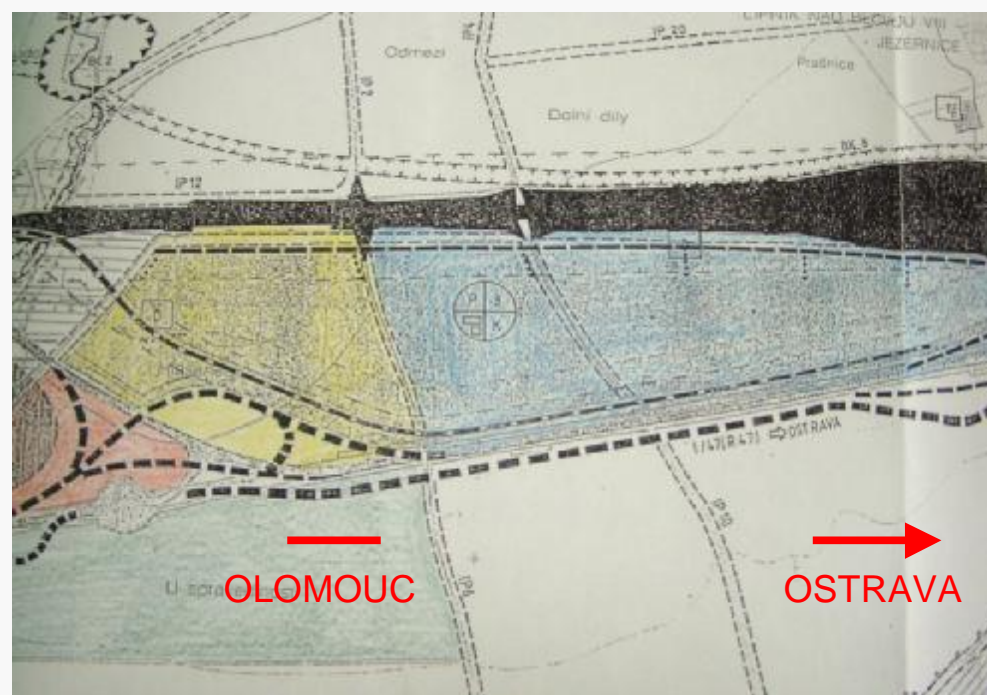

Rozvojové plochy Olomouc - Příkopy



- cca 45 ha
- direct connection to bypass of Olomouc city
- the ownership is not completely solved (red colour - plots owned by the municipality Olomouc)
- complications with drain and increasing prices of plots

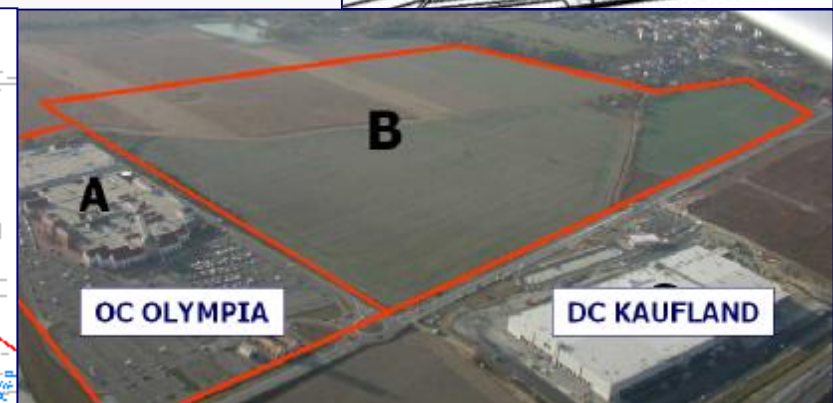
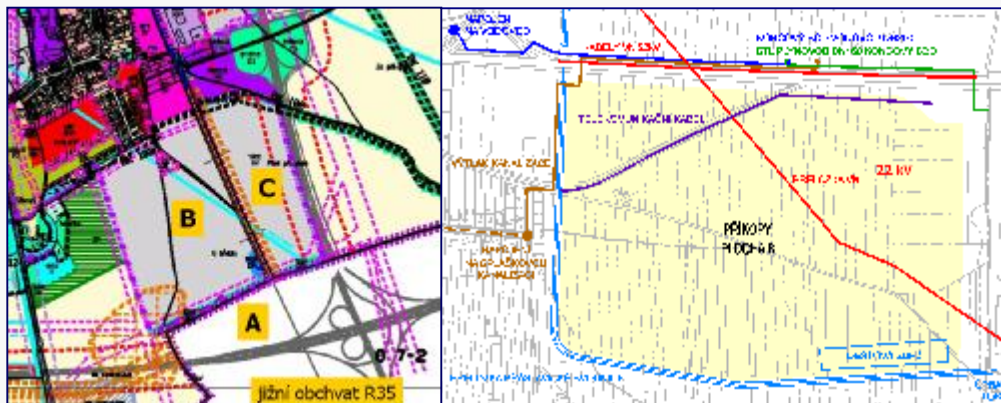

Brownfields



- Střítěž nad Ludinou
- VOP-026 Šternberk
- Neředín barracks

Brownfields

Střítěž nad Ludinou



- site of former potato storage
- **data on main hall:**
- 5,174 m²
- steel-concrete frame, internal ceiling height 6.75 m or 5,40 m
- internal rails between columns of polystyrene, 10 cm

-- these facilities are located on the main premises:

- relief storage 1,495 m² (steel-concrete frame)
- transformer substation
- standby supply
- bridge balance at entrance to site
- administrative building
- site is located 4 km from slip road of newly built D47 highway
- land-use plan is currently being amended

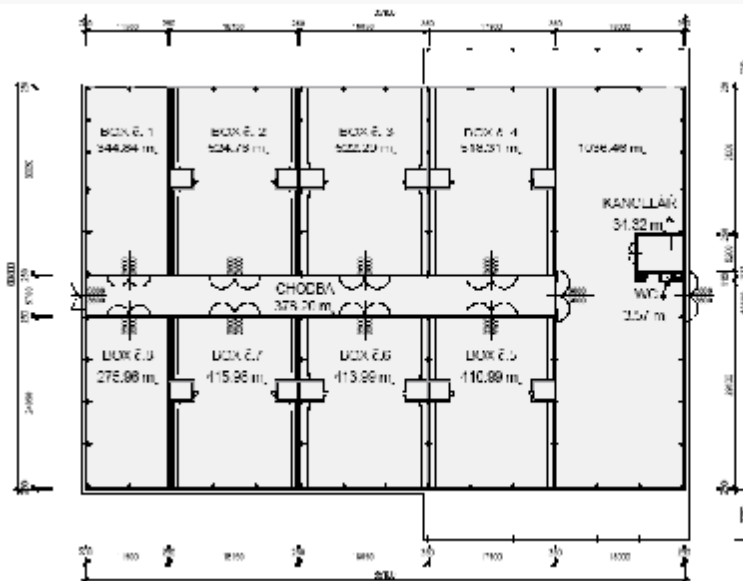

Brownfields

VOP-026 Šternberk



- site of military repair facilities (state company)
- 17 ha of land with 25 halls



BF's Kasárna Neředín



- former army repair facility
- 11,4 ha
- 70% of objects is necessary to demolish
- the ownership is not completely solved (the red colour)



Thank you for your attention

Ing. Pavlína Slepíková

Regional Project Manager
CzechInvest – Investment and Business
Development Agency

Jeremenkova 40B

772 00 Olomouc

Tel: 587 332 187

Fax: 587 332 195

E-mail: pavlina.slepickova@czechinvest.org

www.czechinvest.org